

# the EMERALD

HYDE PARK

INVEST  
IN THE BEST ADDRESS

NATURAL  
PROPERTY

*Legaro*  
PROPERTY  
DEVELOPMENT

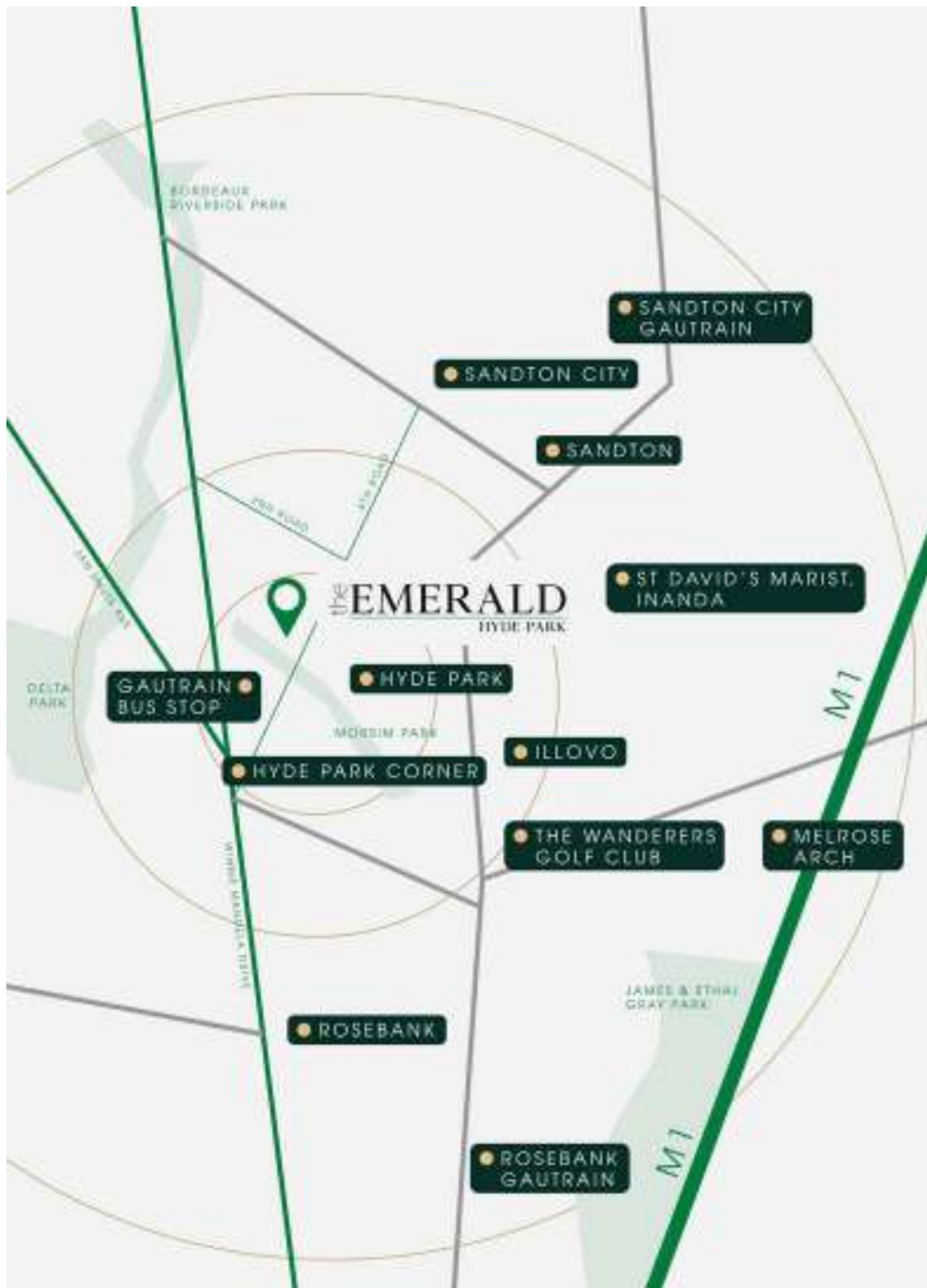

## ABOUT

From Legaro Property Development, the international award-winning developer of Africa's highest-rated green building, comes The Emerald, a luxury residential development that redefines urban designer living.

With its immaculately finished one-, two-, and three-bedroom apartments, its luxurious signature penthouses, its world-class onsite lifestyle centre and its state-of-the-art security and backup power, The Emerald is a gem waiting to be discovered.



1-, 2- and 3- Bedroom Apartments



Signature Penthouse



From R1 999 900



54 6<sup>th</sup> Road, Hyde Park

## LIFESTYLE CENTRE

Welcome to The Emerald Lifestyle Centre, where every aspect of well-being and leisure is catered for.

Designed to elevate everyday experiences, from fitness to wellness, entertainment to family fun, and convenience to business, the Lifestyle Centre offers a seamless blend of relaxation and productivity, ensuring that whether residents are working or playing, they are doing it close to home and in style.



# EXCLUSIVE LIFESTYLE

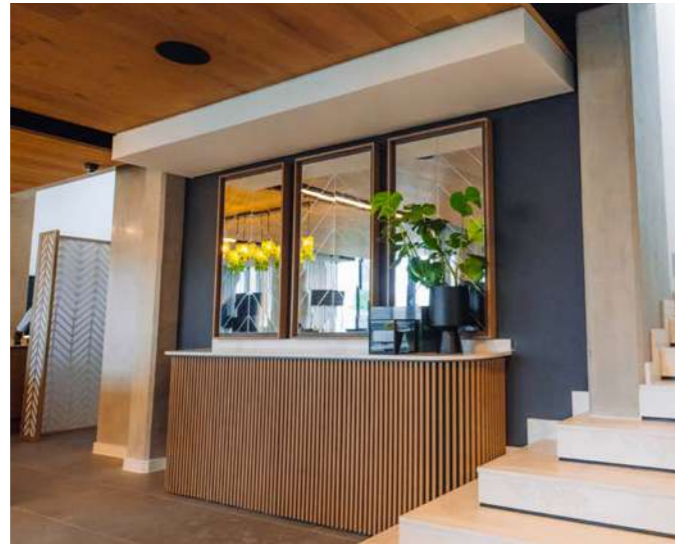

Concierge Service



Meeting Rooms



Business Lounge  
with Wi-Fi



Laundromat run  
by Washpro



Indoor Kiddies  
Play Area



Sky Padel



Fully Equipped Training  
Science Gym



Indoor and Outdoor  
Swimming Pools



Yoga Studio



Steam Room



Ice Recovery Bath



Cryotherapy



Chess Set



Dog Park



# 1-, 2- AND 3- BEDROOM APARTMENTS

Enjoy designer living at The Emerald in Hyde Park.

Each 1-,2-,3- bedroom apartment is generous in their use of space and features the finest finishes. Each luxury apartment includes free:

- SMEG appliances
- Solar PV
- Inverter
- Battery Pack
- 1 Bedroom - 1 Parking Bay
- 2 & 3 Bedroom - 2 Parking Bays
- Storerooms are available at an additional cost



APARTMENTS FROM R1 999 900  
NO TRANSFER FEES OR DUTIES



LUXURIOUS  
LIVING SPACES

FLOOR PLANS

1 BEDROOM LAYOUT



**TYPE Q**  
1 Bedroom | 1 Bathroom | Total Area: 77m<sup>2</sup>

1 BEDROOM LAYOUT



**TYPE S**  
1 Bedroom | 1 Bathroom | Total Area: 79m<sup>2</sup>

2 BEDROOM LAYOUT



**TYPE M**  
2 Bedrooms & 2 Bathrooms | Total Area: 107m<sup>2</sup>

2 BEDROOM LAYOUT



**TYPE R**  
2 Bedrooms & 2 Bathrooms | Total Area: 117m<sup>2</sup>





# THE CROWN JEWEL

## SIGNATURE PENTHOUSE

Nestled at the pinnacle of opulence, the Signature Penthouses redefine luxury living with their unparalleled design, modern amenities and skyline views.

This residence features state-of-the-art SMEG kitchen appliances, allowing culinary enthusiasts to create gourmet meals in style. The Signature Penthouses also include spacious landscaped gardens and timber feature walls.

With advanced solar PV and inverter technology, living spaces remain both eco-friendly and elegant, crafting a meticulous environment that embodies exclusivity. The exclusive transfer-savings promotion offers unparalleled value, making the Signature Penthouse at The Emerald a smart investment for the future.

**SIGNATURE PENTHOUSE FROM R 11 999 900**  
**NO TRANSFER FEES OR DUTIES**



### SIGNATURE PENTHOUSE LAYOUT

3 Bedrooms | 3 Bathrooms  
Total Area: 222m<sup>2</sup> | Garden Area: 169m<sup>2</sup>  
6 Car Garage | 13m<sup>2</sup> Storeroom





# the EMERALD

HYDE PARK

**ON SHOW** Wednesday & Sunday from 2pm – 5pm  
Saturday from 10am – 1pm

**CONTACT** Chris Berdains  
079 287 4002 | [chris@naturalproperty.co.za](mailto:chris@naturalproperty.co.za)

**NATURAL**  
PROPERTY

*Legaro*  
PROPERTY  
DEVELOPMENT

